



# Celltus

Biotech Co.,Ltd.

Cardiac  
Markers

Coagulation  
Markers

Diabetes  
Mellitus

Metabolic  
Marker

Reproduction  
/Fertility

Tumor  
Markers

Renal  
Function

Inflammation

Thyroid  
Function

Infectious  
Disease

**2nd Generation** *(Latest Technology)*

**OPTIMIZED POINT-OF-CARE SOLUTION / HORMONE ANALYZER**

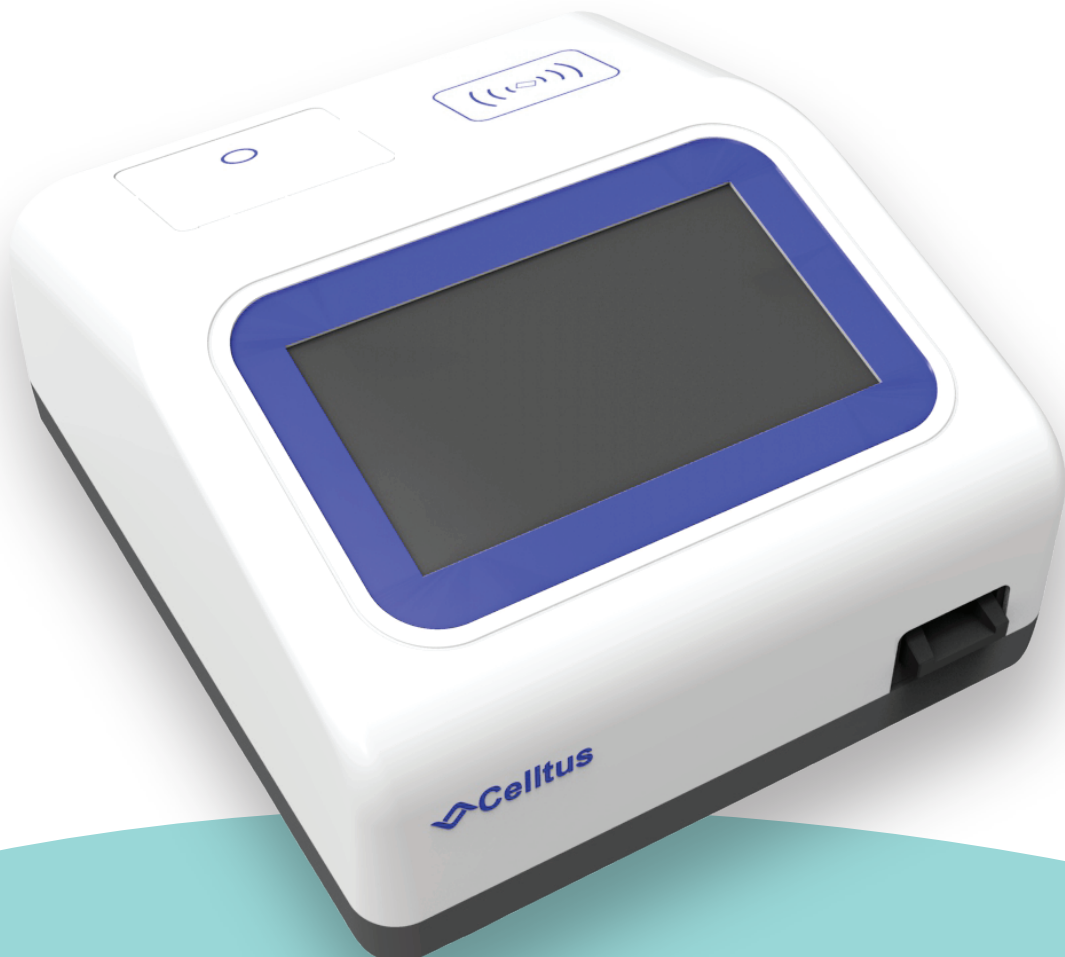

**MAKING TEST EASY**

**CP2000**  
Immunofluorescence Quantitative Analyzer

# CP2000

## Immunofluorescence Quantitative Analyzer



### HIGHLY EFFICIENT & ACCURATE

Advanced fluorescence immunoassay  
Multiple quality control



### REAL-TIME AND RAPID TEST

One-step test  
3-15 min/test  
5 sec/test for multiple tests

## OPERATION MODES

### Inside Mode (single samples rapid test mode)

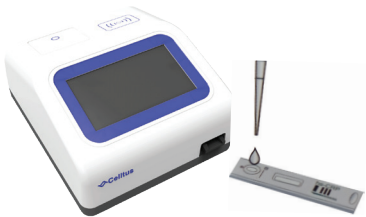

Sample Dispense



Test Card Insert



Click "Start" Icon

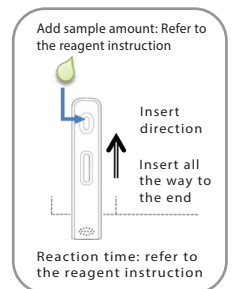

Sample & Reaction

### Quick Mode (mass samples rapid test mode)



Sample Dispense



Timing the Reaction Manually

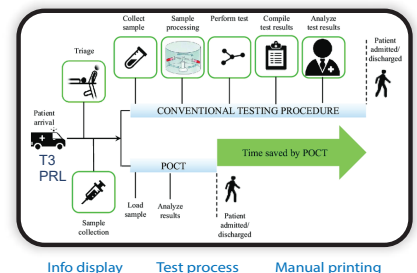

Result Show & Print

# CP2000

## Immunofluorescence Quantitative Analyzer



### CONVENIENT OPERATION

RFID card calibration

Keyboard and mouse connectivity through USB port

Handwriting input available



### USER-FRIENDLY INTERFACE

Android system

## TECHNICAL PARAMETERS

#### Methodology

Immunofluorescence

#### Result

Quantitative

#### Sample Type

WB, Plasma, Serum, Urine

#### Storage Capacity

10000 data

#### Display

7.4 inch Touch Screen

#### Test Speed

240 tests/hour

#### Power Supply

100-240 V-50 Hz/60 Gz, 60 VA

#### Working Environment

Temperature : 10-35° C Relative humidity  $\leq$ 70%

Air Pressure 70.0~106.0 kpa

#### Dimension

261 mm X 241 mm X 115 mm (DxWxH)

#### Weight

3.5 kg

Cat. #	Test Items	Diseases	Cut-Off Value	Sample Types	Measuring Range	Sample Volume	Reaction Time	Qualification
<b>Cardiac Markers</b>								
CP1001	cTnI	Myocardial infarction	<0.3ng/mL	S/P/WB	0.1-50.0 ng/mL	100ul	10 min	NMPA CE
CP1089	BNP	Heart Failure	100.0 pg/mL	P/WB	5.0-5000.0 pg/mL	100ul	10 min	NMPA CE
CP1002	NT-proBNP	Heart Failure	300 pg/mL	S/P/WB	100-35000 pg/mL	100ul	15 min	NMPA CE
CP1005	CK-MB/cTnI/Myo	Myocardial damage /infarction	CK-MB: 5.0 ng/mL cTnI : 0.1 ng/mL Myo : 70 ng/mL	S/P/WB	2.5-80.0 ng/mL 0.1-50.0 ng/ml 30.0-600.0 ng/ml	100ul	10 min	NMPA CE
CP1012	CK-MB/cTnI	Myocardial damage /infarction	CK-MB: 5.0 ng/mL cTnI : 0.1 ng/mL	S/P/WB	2.5-80.0 ng/mL 0.1-50.0 ng/ml	100ul	10 min	CE
CP1014	H-FABP	Myocardial damage	6.36 ng/mL	S/P/WB	1.0-120.0 ng/mL	100ul	3 min	NMPA CE
CP1016	CK-MB/cTnI/H-FABP	Myocardial damage /infarction	CK-MB: 5.0 ng/mL cTnI : 0.1 ng/mL H-FABP: 6.36 ng/mL	S/P/WB	2.5-80.0 ng/mL 0.1-50.0 ng/ml 2.0-100.0 ng/ml	100ul	10 min	NMPA CE
CP1018	CK-MB	Myocardial injury	<0.5 ng/mL	S/P/WB	1-100 ng/mL	100ul	10 min	CE
<b>Coagulation Markers</b>								
CP1006	D-Dimer	Venous thromboembolism	<0.5 mg/L	P/WB	0.1-10.0 mg/L	100ul	10 min	NMPA CE
<b>Diabetes Mellitus</b>								
CP1017	HbA1c	Diabetes Mellitus	4%-6.5%	WB	3%-15%	10ul	5 min	NGSP NMPA IFCC CE
<b>Inflammation</b>								
CP1003	hs-CRP+CRP	Cardiovascular inflammation /normal inflammation	3 mg/L 10 mg/L	S/P/WB Fingertip Blood	0.5-200 mg/L	10ul	3 min	NMPA CE
CP1007	PCT	Sepsis, bacterial infection	0.1 ng/mL	S/P/WB	0.1-50.0 ng/mL	100ul	15 min	NMPA CE
CP1015	PCT/CRP	Sepsis, bacterial infection	PCT: 0.1 ng/mL CRP: 3.0 mg/L	S/P/WB	0.1-50.0 ng/mL 0.5-200.0 mg/L	100ul	15 min	NMPA CE
CP1044	SAA	Bacterial/Virus infection	10.0 mg/L	S/P/WB Fingertip Blood	5.0-200.0 mg/L	10ul	5 min	NMPA CE
CP1090	SAA/CRP	Neonatal sepsis, Bacterial/Virus infection	SAA: 10.0 mg/L CRP: 10.0 mg/L	S/P/WB Capillary Blood	5.0-200.0 mg/L 0.5-200.0 mg/L	10ul	5 min	NMPA CE
CP1088	IL-6	Acute inflammation	<7.0 pg/mL	S/P/WB	3.0-4000 pg/mL	100ul	15 min	CE
<b>Renal Function</b>								
CP1008	CysC	Acute and chronic renal diseases	0.51-1.09 mg/L	S/P/WB	0.5-10.0 mg/L	10ul	3 min	NMPA CE
CP1009	mAlb	Diabetic nephropathy hypertensive nephropathy	20.0 mg/L	Urine	10.0-200.0 ng/mL	100ul	3 min	NMPA CE
CP1010	NGAL	Acute kidney injury	Serum: 200 ng/mL Urine: 100 ng/mL	S/Urine	50-5000 ng/mL	10ul	10 min	NMPA CE
CP1011	$\beta_2$ -MG	Acute and chronic kidney diseases/tumours	0.8-3.0 mg/L	S/P/WB	0.5-20.0 mg/L	10ul	3 min	NMPA CE
<b>Metabolic Marker</b>								
CP1031	25-OH-VD	Osteomalacia, Osteoporosis	30.0-100.0 ng/mL	S/P	5.0-120.0 ng/mL	40ul	15 min	CE
<b>Thyroid Function</b>								
CP1024	TSH	Thyroid malfunction	0.3-4.2 mIU/L	S/P	0.1-100 mIU/L	100ul	15 min	NMPA CE
CP1022	T3	Hyperthyroidism, hypothyroidism	1.30-3.10 nmol/L	S/P	0.5-10 nmol/L	40ul	15 min	CE
CP1023	T4	Hyperthyroidism, hypothyroidism	66.0-181.0 nmol/L	S/P	10-320 nmol/L	40ul	15 min	CE
CP1047	FT3	Thyroid malfunction	2.8-7.1 pmol/L	S/P	0.4-50.0 pmol/L	100ul	15 min	CE
CP1029	FT4	Thyroid malfunction	12 - 22 pmol/L	S/P	0.3-100 pmol/L	100ul	15 min	CE
<b>Blood Protein Function</b>								
CP1004	Ferritin	Iron overload, Infections, Chronic Renal failure, Inflammation	Female: 12.0-150.0 ng/mL Male: 15.0-200 ng/mL	S/P/WB	1.0-1000.0 ng/mL	100ul	15 min	CE
<b>Allergy</b>								
CP1025	IgE	allergic reactions	Refer to User Manual	S/P/WB	1.0-3000.0 IU/ml	100ul	15 min	CE
<b>Reproduction/Fertility</b>								
CP1013	HCG+ $\beta$	Fertility	<5 mIU/mL	S/P/WB	2-200000 mIU/mL	100ul	15 min	NMPA CE
CP1055	LH	Homeostasis fertility regulation	Refer to User Manual	S/P	1.0-200.0 mIU/mL	100ul	15 min	CE
CP1056	FSH	PCOS, infertility evaluation and pituitary disorders	Refer to User Manual	S/P	1-200 mIU/mL	100ul	15 min	CE
CP1066	AMH	Fertility, PCOS, gonadal function, precocious/late puberty	Refer to User Manual	S/P	0.10-20.00 ng/mL	200ul	15 min	CE
CP1048	PRL	Infertility, gonadal disorders	Male: 3.45-17.42ng/mL Female: 4.60-25.07ng/mL	S/P	1.0-200.0 ng/mL	100ul	15 min	CE
CP1071	Prog	Infertility, evaluation of ovulation	Refer to User Manual	S/P	0.10-40.00 ng/mL	100ul	15 min	CE
CP1052	Testosterone	Infertility, evaluation of ovulation	Refer to User Manual	S/P	0.1-16 ng/mL	100ul	15 min	CE
<b>Tumor Markers</b>								
CP1053	tPSA	Prostate Cancer	<4.0 ng/mL	S/P	1-100 ng/mL	100ul	15 min	
CP1050	AFP	Liver Cancer, cancer of ovaries or testicles, etc.	7.0 ng/mL	S/P	2.0-500.0 ng/mL	100ul	15 min	CE
CP1051	CEA	Cancer marker; colon cancer etc.	4.7 ng/mL	S/P/WB	2.0-500.0 ng/mL	100ul	15 min	CE
<b>Infectious Disease</b>								
CP1057	Anti-HCV	Hepatitis C	100	S/P/WB	1.00-20.00 S/CO	100ul	15 min	
CP1058	Anti-TP	Syphilis	1 S/CO	S/P	1.00-50.00 S/CO	100ul	15 min	
CP1064	HBsAg	Hepatitis B	100 IU/mL	S/P	1.00-100.00 IU/mL	100ul	15 min	